

# KIRIT INDUSTRIES

AN ISO 9001:2008 COMPANY

## SELF PRIMING



## MONOBLOCK PUMP



Since 1959

TM

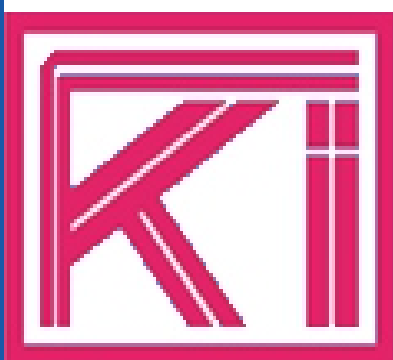



## MAINTENANCE

- 1) **DAILY RUNNING** : It is advisable to run the pump set for a few minutes daily to maintain freeness.
- 2) **IMPORTANT** : Ensure that the casing is filled adequately with water before starting, if the pump set is idle for a very long duration.
- 3) **LEAKAGE THROUGH MECHANICAL SEAL**: Replace the mechanical seal if there is excessive leakage through it. The following precautions to be taken while replacing a mechanical seal failure.
- 4) **AIRTIGHT JOINTS**: Check for airtightness of the joints in the suction pipe and casings.
- 5) **STRAINER**: Ensure that the clogging does not take place in strainer. Clean the strainer periodically.

## WARRANTY CERTIFICATE

Kirit Industries warrants this product to be free from any defects in material and workmanship under normal use and service for 1 year from the date of purchase by the end user, or 18 months from date of invoice whichever is earlier.

Product that fail during this period will be repaired or replaced at Kirit industries discretion, with the same or a functionally equivalent product that:

- A) The product is returned freight paid to our factory.
- B) A copy of sales invoice indicating the date of sale to the end user is provided.

This warranty does not apply to products that are found by us to be damaged:

- A) During shipment, handling or storage.
- B) Due to improper selection, installation or use.
- C) Due to improper voltage operation of the product.
- D) Due to usage of pump for pumping liquid other than clear cold water (temperature of water not exceeding 45 C)
- E) Due to installation, start up, operation that is not carried out in accordance with this manual or when acceptable code of good practice is not followed.
- F) Due to motor getting exposed to strike of lightning.
- G) Due to pump running dry or being operated with intermittent flow of water.

**The maximum liability of this warranty is limited to the purchase price of this product. In no event, regardless of the cause shall Kirit Industries be liable.**

- A) For labour in removing or reinstalling the product.
- B) For any damage caused due to use of product, delay, or loss of profits.
- C) For any incidental indirect or consequential damages even if advised of the possibility of such damages.

Customer Name: \_\_\_\_\_

Address: \_\_\_\_\_

\_\_\_\_\_

Bill No.: \_\_\_\_\_ Date: \_\_\_\_\_

Pump No.: \_\_\_\_\_

# PERFORMANCE TABLE - DISCHARGE IN LPH

## 50Hz, 240V For Single Phase, 2880 RPM

Model	K.W	H.P	Size in m.m	Head in Metres								
				6	9	12	15	18	21	24	27	30
KI-SW-5	0.37	0.50	25 X 25	1800	1584	1332	1044	700	576	252	-	-
KI-SW-10DC	0.37	0.50	25 X 25	2550	2300	2100	2000	1600	1450	1250	1000	650
KI-SW-20	0.81	1.10	25 X 25	3200	3050	2700	2250	1850	1650	1450	1250	850

Available in aluminium cast iron body.

**Note:** As the design and manufacture of our products are subject to constant improvement the products supplied may differ in some details from the specifications & illustrations given.

To avoid blockage of strainer with mud

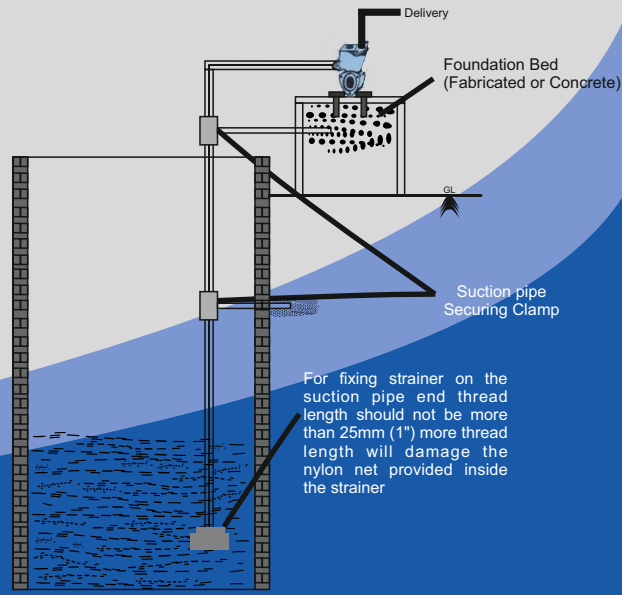

### OPERATION

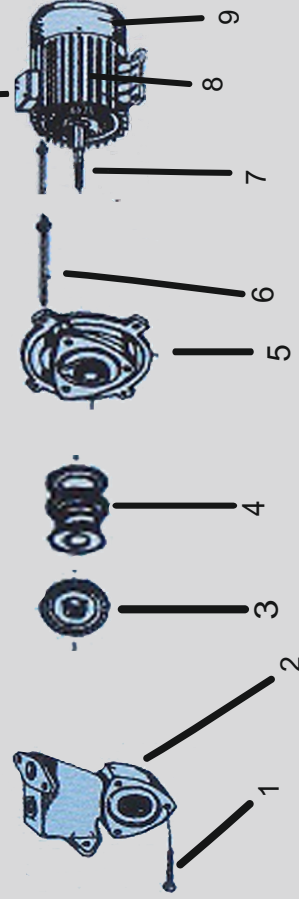

Part No.	Description
1.	Volute Casing Fixing Bolt
2.	Volute Casing
3.	Impeller
4.	Mechanical Seal Unit
5.	Adaptor
6.	The Rod for Motor Fixing with Hex Nut
7.	Rotor with Shaft
8.	Motor Body
9.	Terminal Cover
10.	Cooling Fan Cover

## 1. GENERAL

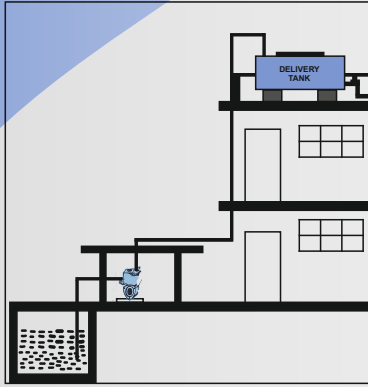

The figure represents the installation of the pump within lightning weight, no special foundation is needed. Just Place the pump on the ground level over a base, or you can hang inside the well.

Though the pumps are self priming at static suction lift upto 8m (26 feet) at mean sea level. please note that the vertical distance between the centre line of suction flange of the pump and water level should "Not" be more than 4.5m (15 feet) for satisfactory discharge. This will also help even if there were further draw down of the water level.

2) **Bends** : Ensures minimum number of bends and airtight joints.

3) **Clearance** : Maintain sufficient clearance of minimum 5 cm (2") between the suction pipe bottom and sides of the tank. In case Pumpset installed on open well then clearance should be minimum 0.5 (1.5") between pipe end, bottom of well and surrounding.

## ➡ PIPING

1. Use pipe sizes as specified on the name plate.
2. Always Use Anerobic pipe sealent or Teflon Tape for pipe Joints. Avoid use of gunny pieces or jute ropes.
3. No Foot Valve is required for Self Priming Pump.
4. Please take care to fit the special Non Return Valve in the Correct Position.
5. Fix a Strainer at the lower end of suction pipe.
6. Do not remove the Non Return Valve.

## ➡ PRIMING THE PUMP

This Pump is of the Self Priming type. It is necessary to fill water into the casing once during installation and tighten the filter cap properly. Now start the pumpset and wait about 4 to 5 minutes to get the water initially at max suction lift. During Consecutive operations you will get water immediately after switching on the pump. Switch off the pump before the water level goes below the suction pipe or when there is no water in the pipe line.

1. **Wiring:** Connect the motor with correct size of cable.
2. **Important:** Never run the pumpset with gate valve closed, if provided at delivery side. Do not run the pumpset dry to prevent damage to mechanical seal.

TYPICAL OPENWELL INSTALLATION OF MONOBLOCK PUMPS

Now your pumpset is ready to deliver water to your requirement.